

Vaping is a type of delivery system for extractions (concentrates) that produces inhalable aerosol that can be fast-acting and smoke-free.



Aqualitas uses the 510-Threaded Battery and Cartridge System. This is an open-loop design that allows users to attach universal 510 cartridges to 510-threaded batteries.

For the best results from our concentrates, a 3V battery is recommended. Vape pens and batteries are sold separately.

**Q.** Is vaping cannabis safe?

The public and medical communities are still learning about the impact of vaping concentrates on health. The cutting agent vitamin E acetate and flavouring are not permitted in vapes due to safety concerns. Our small batch formulations are made with our own certified organically grown flower without synthetic fertilizers or pesticides. Our process is designed to refine our cannabis oil, and we do not use cutting agents or flavouring as ingredients in our process. Our products are 100% cannabis plant and their terpenes.

Health Canada has also provided information on cannabis vaping [link here](#).

**Q.** How do I put the cartridge and battery together? And take it apart?

**Assembly** —Ensure batteries are fully charged before use. When ready to use, clients should screw cartridges clockwise into battery units. **DO NOT** overtighten or twist too hard, you could strip the threading.

**Activation** —Most, if not all, are either breath-actuated or push-button activated. Clients should refer to their user guides for specific operational instructions on each product.

**Deactivation** —Remove cartridges by unscrewing them counterclockwise from battery unit. If using push-button battery, clients should ensure their devices are turned off prior to storage or transportation.

\*\* the battery and cartridge should be disassembled and stored when not in use

\*\* let the battery drain its charge completely BEFORE recharging it

**Q.** How do I store my battery & cartridge? Can they stay attached when not in use?

**Storage and transport:**

We advise you to:

- Handle all vape pens with care
- Store vape pens in cool, dry locations between 4° -30°C
- Never expose vape pens to direct sunlight for prolonged periods
- Never submerge vape pens in water
- DO NOT transport filled cartridges via airfreight

## Cartridges

- Disconnect cartridges from batteries and store them in cool, dry locations when not in use.
- Never leave cartridges in extremely hot or cold vehicles, or to directly expose them to sunlight for prolonged periods.
- Don't subject vape pens to extreme elevation changes.
- If a client plans to subject a vape pen to extreme elevation change, they should store it upside down while doing so.
- Always stow pre-loaded vape pens in accordance with provincial and federal laws when driving.
- Never travel internationally with any cannabis products or accessories.

### Q. What is the dose when vaping?

There is **NO such thing as a standard vaping dose**. Dosages vary for each client and strain type.

Factors:

- User size and weight
- Health
- Cannabis tolerance levels
- Length of a typical draw
- Mood
- Strain type and potency

As with all cannabis products, we suggest clients employ a cautious “Start Low and Go Slow”. When vaping concentrates you don't need to inhale as hard — it is not like smoking— it's mist vapour- and is a completely different experience.

*E.g. cycle of 1-2 draws of 3 seconds or less; 30-minute waiting period; repeat*

These concentrates can only be vaped using a cannabis concentrate vape pen designed for a variety of viscosities.

### Q. How will you know when the cartridge is finished?

- A cartridge is finished when there is only residue remaining at the bottom of the cartridge.
- Empty cartridges can produce harsher tastes and burnt flavours when vaped.

### Q. How long does a vape pen last?

There is no standard answer to this question for multiple reasons:

- Differences in reservoir capacities
- Temperature settings
- Various materials comprising cartridges and pods
- Different concentrate formulation types and viscosities
- User inhalation habits, including draw frequencies and lengths

### Q. Are vape pens re-fillable?

Cannabis vape pens are preloaded with varying formulations. With the exception of their batteries, these units must be discarded once they reach the end of their lives and are not intended to be refilled.



### Q. What happens if my cartridge gets clogged?

- It is advised to store any clogged vape pens upside down after use.
- You can unclog push-activated vape pens by using a technique referred to as “priming the cartridge”. This involves preheating the vape by turning on the battery, then pressing and holding the button for 5 seconds.
- Unclog breath-actuated vape pens by gently inserting a toothpick into the devices’ mouthpiece as far as it will go. This process should be repeated 2-3 times until blockage is cleared.

### Q. What if the vape pen is not working?

- Ensure the battery is fully charged. If the battery is low or drained, an LED light will flash.
- Try removing the cartridge from the device, then re-attaching it by screwing it clockwise into the battery unit. DO NOT overtighten the cartridge.
- If vape pen is still not working, try troubleshooting the anode (*see below*).

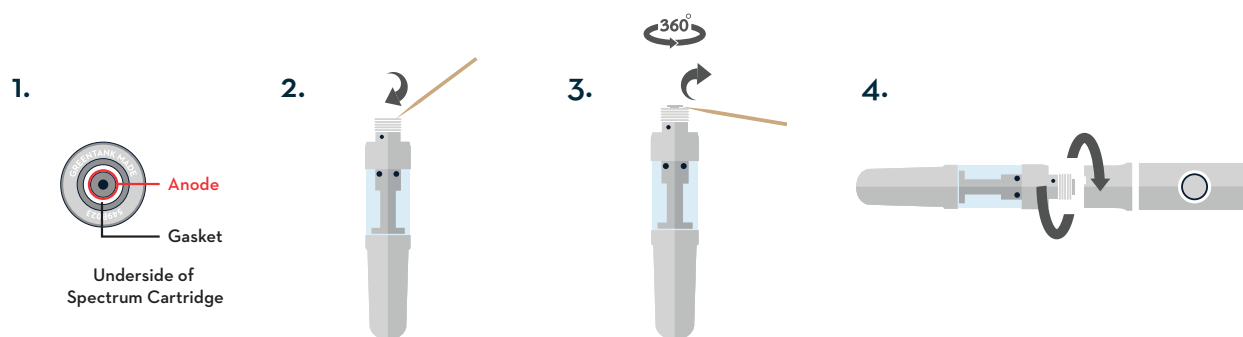

1. Identify anode.
2. Place fingernail or toothpick under anode.
3. Gently rotate anode in either direction until it is slightly raised above silicone gasket (approximately 1 mm or 0.04 inches).
4. Screw cartridge clockwise into battery.

*\*Note: Do not fully pull anode out of cartridge. If unit still does not work after troubleshooting, clients should return it to its place of purchase.*

### Q. What if the cartridge leaks?

- Concentrate residue at the bottom of the cartridge is not considered a leak. It is normal to have a small amount of residue appear as the cartridge nears the end of its life.
- If you notice an above-average amount of any concentrate or extract leaking from the bottom of the vape cartridge, stop using it and discard it immediately in a safe, responsible manner.
- If you notice liquid coming through the top of the mouthpiece, the concentrate has oversaturated the ceramic, stop using it and discard it immediately in a safe, responsible manner.



Aqualitas Client Support Centre

Client Care PO Box 310, Brooklyn, NS B0J 1H0

Tel: (902) 354-3736 | Toll-Free: 1-833-300-AQUA (2782)

Secure Fax: 1-855-750-1884 | [clientsupport@aqualitas.ca](mailto:clientsupport@aqualitas.ca)